



WEBSTER INDUSTRIES

COMBO-BELT

YOUR LINK TO TOTAL VALUE



websterchain.com

800-243-9327

ISO9001 Certified

COMBO-BELT



Combo-Belt is made from a variety of material combinations, including steel bushed roller (SBR) chains, combination chains, and welded steel mill chains, giving Combo-Belt unlimited application possibilities. Webster's standard design incorporates two strands of chain, support channels or cross bars, a rubber or PVC belt, and pusher cleats. Combo-Belts are available from 12" to 120" wide, and are particularly applicable for recycling, waste and food processing conveyors. Combo-Belt moves fine or delicate product while having an application-specific chain design.



MATERIAL

Combo-Belt conveyors are available in a variety of options. Cleats, stiffeners and wear pads are mild steel. Sidebars and pins can be furnished with additional heat treatment on request, and bushings are furnished in case-hardened steel to provide maximum wear resistance and chain life. Rollers are WEBLOY for increased life, and can also be furnished in Duramal.

ASSEMBLY

Combo-Belt conveyors are cotteder construction, and are available in customizable strand lengths for ease of assembly.

APPLICATION

Combo-Belt conveyors are used in recycling and food processing facilities where a lightweight conveyor is required.

INTERCHANGEABILITY

Combo-Belt chain components and belts are fully interchangeable with other standard makes of corresponding sizes and numbers.

OPERATION

Combo-Belt conveyors are ideal for slow or moderate-speed applications. Maximum chain speed depends upon sprocket size. Conveyor speed is detailed in Table 2, Section A, in the 400 Master Catalog.

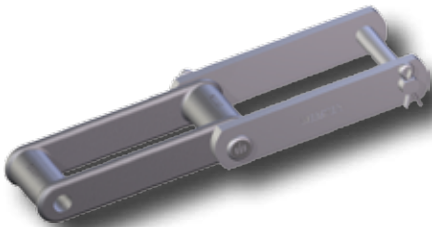

COMBINATION CHAINS

Combination chains are manufactured using hardened cast links, steel sidebars and heat-treated steel pins. Combination chains alternate steel sidebars and cast links, making them ideal for handling abrasive material in corrosive environments. Combination chains come with a variety of standard attachments for immediate delivery. Special or custom attachments are also available per customer request.

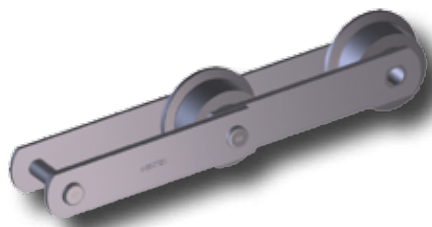

SBR CHAINS

Steel bushed roller (SBR) chains are manufactured with heat-treated rollers, hardened bushings and pins, and steel sidebars. The roller-type construction provides a lower operating friction, which helps increase chain life and reduces conveyor design requirements. SBR chains are available in a wide variety of sizes, configurations and designs, and can be used in tough industrial applications.



MILL CHAINS

Welded steel mill chains are manufactured with heat-treated pins, steel sidebars and barrels. Mill chains are furnished in various configurations of pitch, construction and heat treatment to suit each operating environment. Their simple, yet rugged, construction makes them ideal for the recycling industry. Mill chains are readily available from stock with custom and standard attachments.



COMBO-BELT SPECIFICATIONS

AR SIDEBARS

Sidebar for Combo-Belt are typically offered in standard 4", 5" and 6" sizes, depending on the application.

CLEATS

Mitered angle cleats are standard on Combo-Belt. Custom configurations with alternating spacing and sizing are available.

BELT

Common belt options for Combo-Belt include the following: 220 2-ply, 330 3-ply, 440 4-ply, 250 PVC, 350 PVC and 450 PVC. Custom belt options are available upon request.

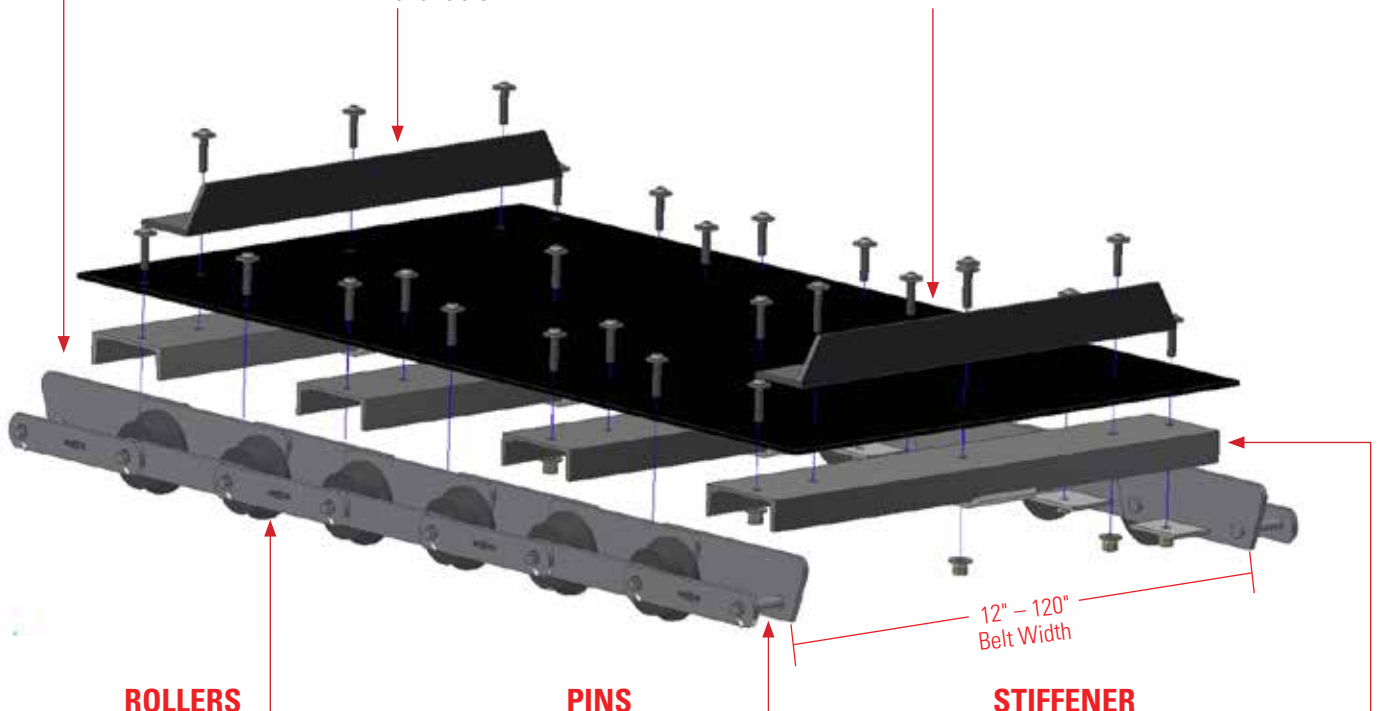

ROLLERS

WEBLOY white iron rollers, cast in the Webster foundry, are standard on Combo-Belt. Machined rollers and rollers with bearings are also available upon request.

PINS

Both standard pins and pins drilled for lubrication are available for Combo-Belt, depending on the customers' needs.

STIFFENER

Stiffener options include flat bar with wear pads or C-channel with wear pads, as determined by the width of the belt and pitch of the chain.

CUSTOM DESIGN

Webster's line of Combo-Belt conveyors is not limited to standard designs. We have the engineering and manufacturing capabilities to meet individual project requirements, whether a standard conveyor requirement is needed, modifications are required, or a complete new system must be designed. Webster's ability to design and manufacture application-specific chains and belts enables us to supply the proper conveyor for the application.

VERTICAL INTEGRATION

Webster products are manufactured at our Tiffin, Ohio location, which includes a malleable iron foundry, punch press operations, heat treat facility, machine shop, sheet metal fabrication department, chain assembly area, in-plant laboratory and testing facilities. Our vertically integrated system ensures quality products and efficient product management, minimizing down time for our customers.

MARKETS



COMPOST AND ORGANICS



PULP AND PAPER



DEMOLITION AND CONSTRUCTION



FOOD PROCESSING



SIMPLE STREAM RECYCLING



MUNICIPAL SOLID WASTE



★ ISO Certified

800-243-9327 • websterchain.com

No. 601 -7/16
Printed in the USA-RRD/2M